



4 Elma Street WILBY VIC

4 2 4

Located just 15 minutes from central Yarrawonga you will be delighted by this impeccably presented Wilby home.

The home takes advantage of comfort and space with a functional floor plan design providing ample relaxed living. Cosy up in front of the gas log fire in the lounge room or spread out and unwind on the front veranda or large alfresco area out back.

Offering generous sized bedrooms, the master with ensuite, walk in robe plus bonus BIR, separate family bathroom and substantial kitchen and dining areas. Split system heating and cooling plus ceiling fans ensure year-round comfort.

Situated on approximately 8,107sqm, this property also

[For full version visit the website](https://www.kennedyrealestate.com.au/8395346)

Type : House
Land Size : 8107 sqm
View : <https://www.kennedyrealestate.com.au/8395346>

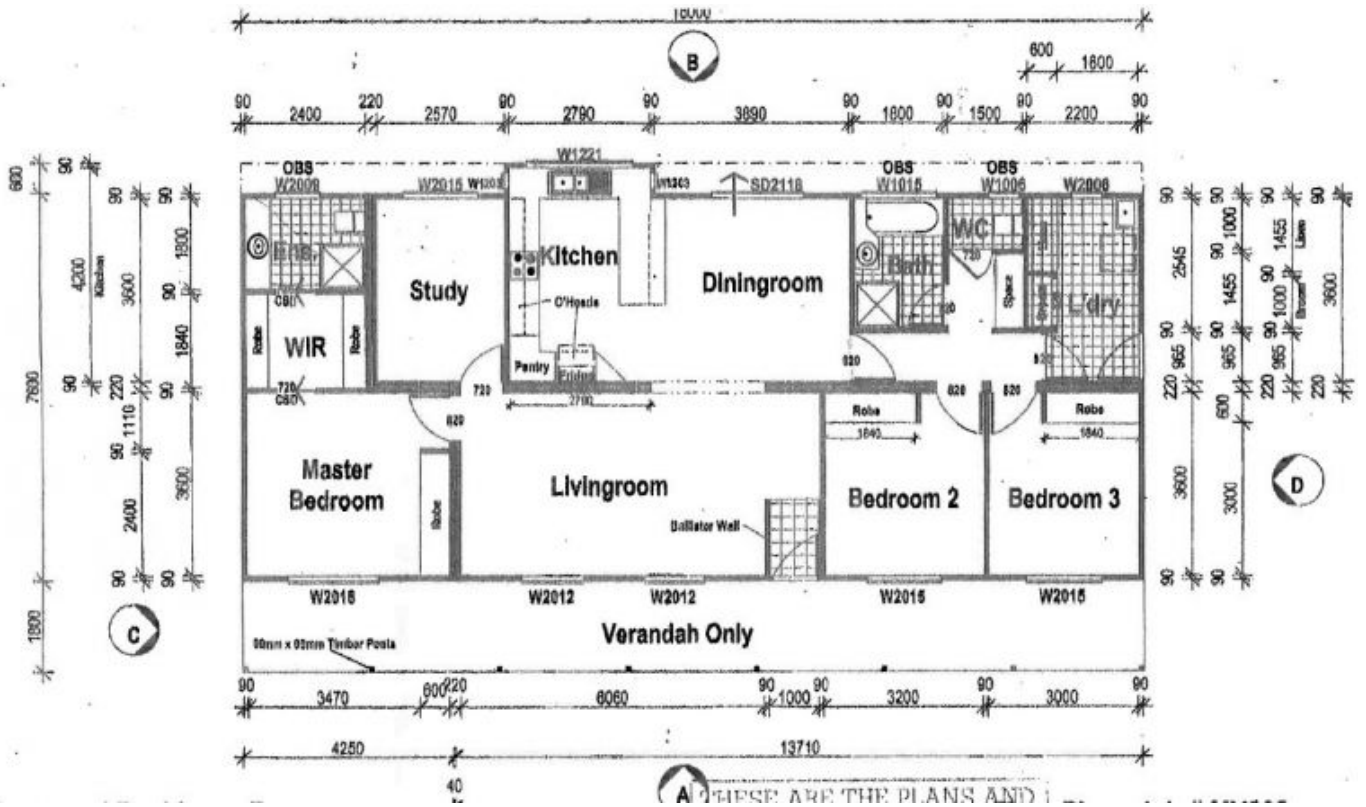

A THESE ARE THE PLANS AND