



9/128A Murray Valley Highway YARRAWONGA VIC

2 2 1

Fabulous renovated trendy townhouse within walking distance to the main street with supermarkets, cafes and hotels. Overlooking a huge resort style pool this townhouse offers a living room, new kitchen with hot plates and oven, new timber flooring, two generous sized bedrooms with built in robes, two new bathrooms and undercover parking with direct access. The ideal first home, investment or holiday residence. All this with the added advantage of a huge secure lock up shed.

Type : Unit

View : <https://www.kennedyrealestate.com.au/8395469>

9/128 MV HWY



GROUND FLOOR

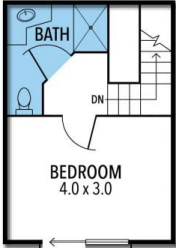

FIRST FLOOR

THE ABOVE PLAN IS AN ARTIST'S IMPRESSION ONLY, IT INCLUDES ELEMENTS THAT ARE FOR DISPLAY PURPOSES ONLY AND MAY NOT BE TO SCALE. LANDSCAPING SHOWN IS INDICATIVE ONLY. DIMENSIONS ARE APPROXIMATE.

